

**Part Number: GC2325-2**  
**Reed Switch**  
**Product Data Sheet**

**PICTURE**



✓ **RoHS Compliant**

**FEATURES**

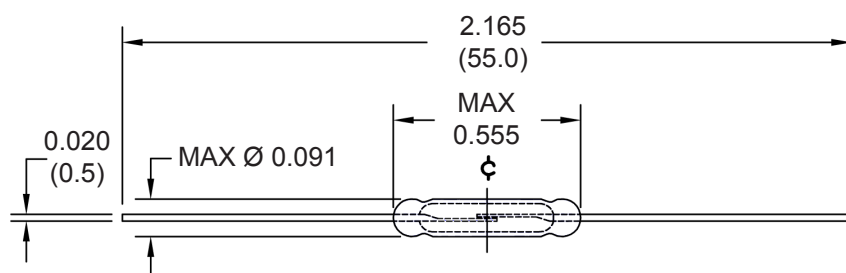
- Resistant to Ambient Environmental Conditions
- Construction : Rhodium Contacts
- Mechanical Stress Resistant
- Antivibration Feature
- Glass Switch
- Test Coil #1035

**DIMENSIONS**

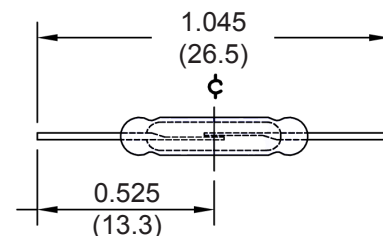
Reed Switch Length Before Cut



Reed Switch Length After Cut

Drawings not to scale.  
 All dimensions in inches (mm) nominal.

**SPECIFICATION**

Switching Capacity	10 VA, 10 W MAX
Switching Voltage	100 VAC MAX
Switching Current	0.5 A MAX
Initial Contact Resistance	150 mOHMS MAX
Insulation Resistance	10 <sup>11</sup> OHMS MIX
Dielectric Strength	250 VDC MIN
Standard P.U. Range	10 to 12 A.T. (before cut)
Release Range	5 to 25 A.T.
Switching Frequency	200 cps MAX
Operate Time	1.8 ms MAX
Release Time	0.03 ms MAX
Bounce Time	0.2 ms MAX
Operate Temperature Range	-55 to 150°C

As part of the company policy of continued product improvement, specifications may change without notice. Our sales office will be pleased to help you with the latest information on this product range and the details of our full design and manufacturing service. All products are supplied to our standard conditions of sale unless otherwise agreed in writing.

**Phone: (1) 973 777 6900**

**www.comus-intl.com**

**Fax: (1) 973 777 8405**

Belgium: + 32 (0)12 390400 - Assemtch, UK: +44 (0) 1255 862236 - Germany: +49 (0)911 923 15 943  
 ©2011 Copyright Comus International, 454 Allwood Road, Clifton NJ 07012, USA

An ISO 9001 Certified Company